

hızlı çözümler sunan  
**mekanik ve pnömatik sistemler...**

mechanical and pneumatic  
**systems those present quick solutions...**



**TREX**   
serial

[www.toggleclamps.com.tr](http://www.toggleclamps.com.tr)  
[www.clamp.com.tr](http://www.clamp.com.tr)



• Bir ihtiyaç, bir merak, yeni bir ürün oluşturma, marka geliştirme, talep karşılama dürtüleri ile oluşturulan, yedi yıl önce piyasaya sürülmesiyle hayat bulan bir marka CLAMP Hızlı Bağlama Elemanları. Kötüyü eleyerek, zayıfı iyileştirerek, iyisini / yenisini oluşturmaya çabalayarak meydana getirdiğimiz bir ürün portföyümüz var. Daha kat edecek çok yolumuz da var...

Biz bazen ağır, bazen koşarak, bazen de geri adım atarak ilerlemeye çalıştığımız bu yolda; ihtiyaçları ve talepleri; gözlemlerimiz, tasarımlarımız ve üretimimizle birleştirerek ürüne çevirmek için gayret ettik. Kalitenin ucuz elde edilemeyeceğinin ancak çok pahalı da olmadığını inancı ile ürettiğimiz ürünlerimizi. Ve bu inançla sunduk müşterilerimize markamızı...

Bugün yurtiçi ve yurtdışından gelen talepler doğrultusunda doğru yolda olduğumuza inanıyoruz. Yine bu mantalite çerçevesinde oluşturacağımız ürünlerimizi ve projelerimizi, sizlerin beğenisine sunmaya devam edeceğiz...

• A trade mark which was formed with the impulse of a need, an interest to create a brand to meet the demands and that sprung to life since the launch to the market : CLAMP Quick Fasteners... We have a portfolio of products which we composed by eliminating the lousy, by recovering the feeble and by struggling to form the best / the newest. And there is still a long road to cover.

We have endeavoured a lot in this target for a progress by combining the needs and demands with our observations, designs and production; sometimes very hardly, sometimes in a rush and sometimes by a withdrawal. We have manufactured our products with the faith of "Quality can not be caught in a cheap way but it is not an expensive fact also" And with these faith we have presented our products to our clients...

Nowadays; with the orders coming from locally and from abroad, we believe that we are in the right direction. And we will keep going to serve our products and services for your taste by forming them within the frame of this mentality ...



• Clamp Hızlı Bağlama elemanları, üzerinde işlem yapılacak parçayı, sıkıştırma, kenetleme, çekirme usulleriyle sabitleyerek, operatörün parça üzerindeki işlemini kolay ve hatasız yapmasına olanak tanır. Her modelin farklı ayak tipi ve ebatları sayesinde paçanın boyutu ve konumlandırıldığı yere göre sabitlendirilmesi sağlanır.

• Clamp Quick fasteners let the operator to do his job easily and without false by fixing the part operated by clenching, clamping and pulling methods. Because each model has different leg type and different size, they provide fixation up to the dimension and positioned area.



• Sabitleme konularının haricinde kilitleme konularında da kullanılan Clampları mevcuttur. Yüksek basınca karşı kuvvetli, titreşim ile kapağın açılmasını engelleyen özel kilit mekanizmasıyla, özellikle kazan kapakları ve makine kapaklarının kapanmasında Kançalı Clampları kullanılmaktadır.

• Besides fixation cases, there are also clamps for locking cases. Hooked clamps tolerable to high pressures are used especially in boiler lids and machine lids with its special lock mechanism that prevents the opening of the lid with vibration.



- Clamp Hızlı Bağlama elemanlarının dikey tip, yatay tip ve kancalı modellerindeki çalışma hareketleri görülmektedir.
- The vertical, horizontal and hooked fast binding elements of clamp's work practices can be seen.

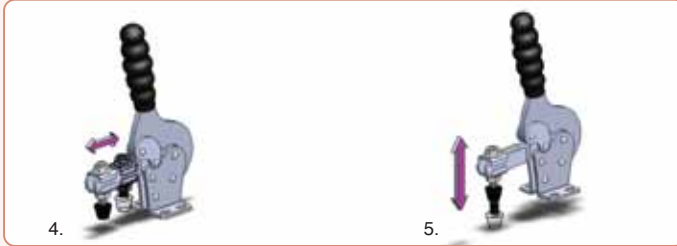

- Clamp'ların baskı civatası takımı yukarı - aşağı ve ileri - geri hareket imkanı sunarak sıkıştırılması istenen iş parçasına uygun bağlama biçimi sağlar.

- Pressure bolt kit of the clamp with back and forth movement opportunities provides suitable binding of the workpiece to be compressed.

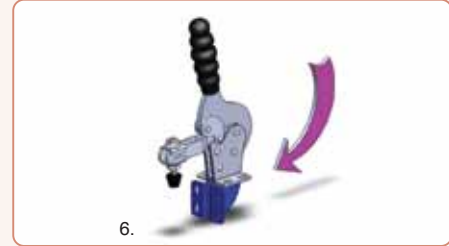

- Clamp'ların farklı tiplerdeki mekanizma ayak yapılarına göre bağlanmak istenilen ortamlara göre uygun yapı oluşturur.

- Suitable structure can be formed according to the intended binding situation along with the different types of leg structure of the Clamp mechanisms.

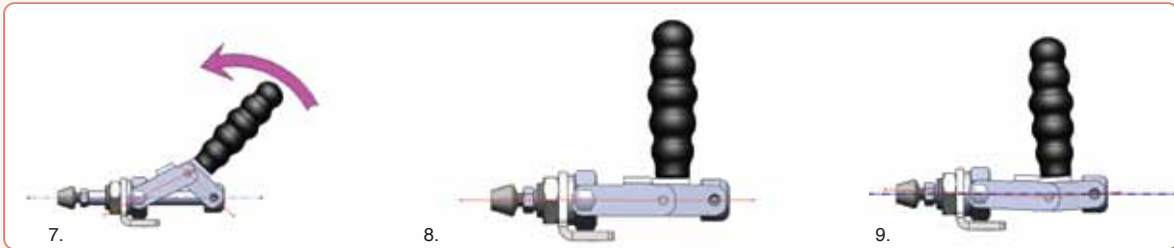

- Clamp'ların temelde çalışma prensibinde kilit sistemi 7. - 8. - 9. şekillerdeki sıralamaya göre açık konum - düz konum ve kilit konumu olarak özetlenebilir. Kilit konumunun temeli ortadaki pim merkezinin parçanın ekseninin altına düşüp stoplanması durumudur.

- The basic work principle of the clamps can be summarized as locked and unlocked types as in 7. - 8. and 9th forms. The rationale of the locked position is based on the stopping of center pin in the middle when it falls under the axis.

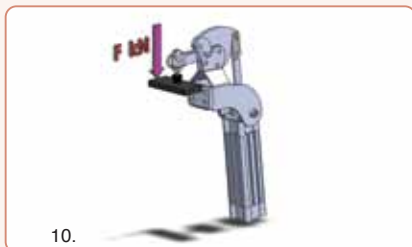

- Clamp'ların kilit esnasında iş parçasına uyguladığı baskı kuvveti, Clamp'lerin farklı model ve boyuttaki yapılarına göre uygun değerlerde kuvvet oluşturarak optimum model seçimi sağlar.

- The pressure force of the clamp to the workpiece during locking provides optimum model choice by forming fair value of force according to the different structure size and model of the calamp.

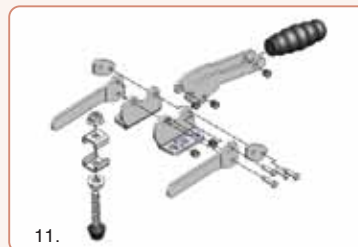

- Şekildeki montaj patlak görüntüdeki örnek clamp modelinin parçaları görülmektedir. Çelik sac aksamı yüksek kaliteli ve yüksek mukavemet değerli sac malzemeden imal edilmiştir. Montaj perçinleri kaliteli paslanmaz çelik malzemeden üretilmiş, yataklama burçları ısıtılmış ve yüksek mukavemet değerli endüstriyel yağ ile

yağlanmış çelik burçlardır. Plastik kol kaliteli kompozit malzemeden, uygun ergonomik yapıda ve el boğumuna uygun tutma yapısına göre üretilmiştir. Tüm bu parçaların biraraya gelmesiyle yüksek kaliteli Clamp ürünleri oluşmaktadır.

- 11 The components of the sample clamp in flat installation can be seen in the form. Steel sheet component is produced from high quality and high durable sheet metal. Installation rivets are produced with high quality rust-free steel material. Steel bedding bushes are oiled with heat-treated, high durable industrial oil. Plastic handle is produced with high quality composite material according to suitable ergonomic design and proper to hand nodes. High quality Clamp productions are produced by gathering all these components.

100



Yüksek kaliteli çelik sac aksamı, Isıl işlemleri, yağlanmış yataklama burçları ve Paslanmaz Perçinler, Kolay kavranabilen ergonomik, plastik kol özellikleri ile CLAMP Hızlı Bağlama Elemanları kolay çözümler sunar...

High quality steel sheet components, Heat processed, lubricated bushing bearings Stainless Rivets, Easy grabbing ergonomic plastic handle featured CLAMP Fast Clamping Components offer easy solutions...

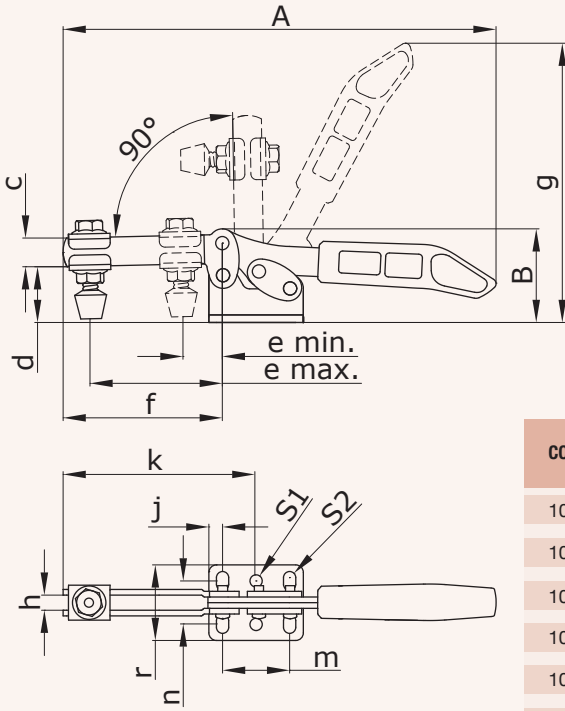

CODE NO	A	B		Gr	Pressure Force Between e-max. - e-min. (kg)	PASLANMAZ STAINLESS
100 V	86	26	M4x30	49	30-40	X100 V
100 Y	147,5	34	M5x35	120	80-120	X100 Y
100 Z	169	43	M6x35	175	110 - 220	X100 Z
100 A	229	50	M8x60	335	190 - 380	X100 A
100 B	293,5	70,50	M8x82	715	250 - 500	X100 B
100 C	348	87	M10x95	1300	400 - 800	X100 C

CODE NO	c	d	e min.	e max.	f	h	j	k	m	S1	S2	n	r	g	PASLANMAZ STAINLESS
100 V	7	17,5	9,5	27	33	4	5	-	14	-	Ø4x6	16	24	62,5	X100 Y
100 Y	10	21	12,5	39	47	5	5,5	-	23	-	Ø5,5x7,5	21,5	33	104	X100 Y
100 Z	14	26,5	16	48,5	59,5	6,5	7	-	23,5	-	Ø5,5x10	23	38	112,5	X100 Z
100 A	15	29,5	20	71	85	8	7	102	35,5	Ø6,5	Ø6,5x10	23	40	148	X100 A
100 B	22	41	28	93	109	10	12	130	42	Ø8,5	Ø8,5x12,5	36	58	197	X100 B
100 C	26	53	35	114	133	12	15	158	50	Ø10,5	Ø10,5x15	37	62,5	242	X100 C

102



Yatay Bağlama Elemanlarının, farklı ayak yapısına sahip bu modelleriyle çeşitli pozisyonlarda montaj yapılabilir.

By means of these models of Horizontal Clamping Components, assembly in different positions is possible.

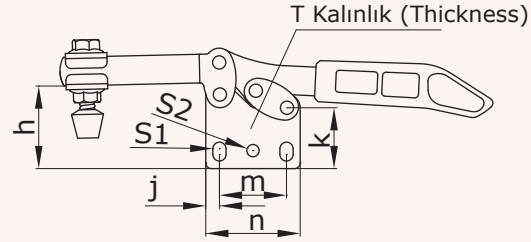

CODE NO	h	j	k	m	n	S1	S2	T	PASLANMAZ STAINLESS
102 V	27	5	22	14	24	Ø4x6	-	4	X102 V
102 Y	34	5,5	27	23	34,5	Ø5,5x7,5	-	5	X102 Y
102 Z	41,5	7	34	23,5	37	Ø5,5x10	-	5	X102 Z
102 A	44	7	32	35,5	50	Ø7x10	Ø6,5	6	X102 A
102 B	65	12	55,5	42	66	Ø8,5x12,5	Ø8,5	8	X102 B
102 C	78	15	67,5	50	80	Ø10,5x14,5	Ø10,5	10	X102 C

104

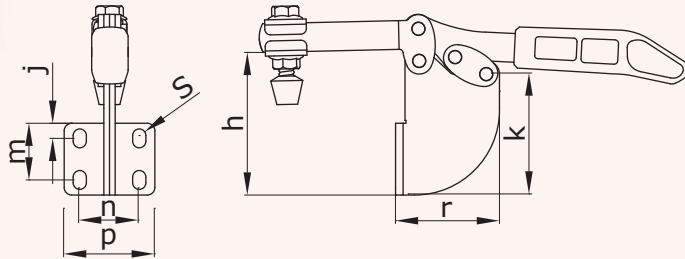
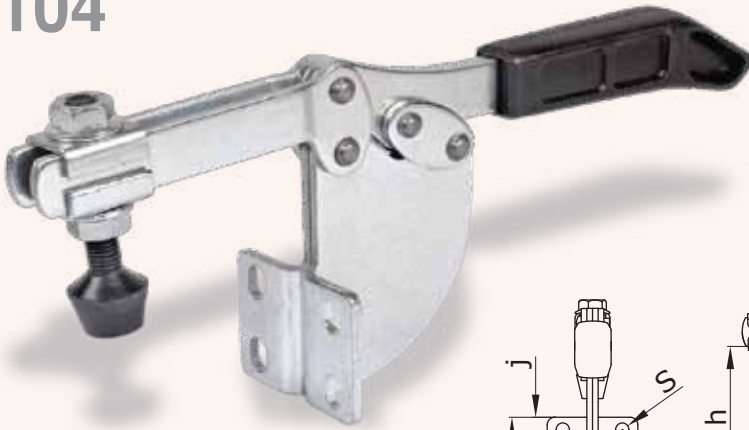

CODE NO	h	r	k	j	m	n	p	s	PASLANMAZ STAINLESS
104 V	45	27	40	5	19	16	24	Ø4x6	X104 V
104 Y	54	38	47	5,5	28,5	21,5	34,5	Ø5,5x7,5	X104 Y
104 Z	63	39	56	6,5	30	33,5	48	Ø5,5x10	X104 Z
104 A	75,5	55	64	8	30	31,5	48	Ø7x10	X104 A
104 B	123	75,5	114	12	54	36,5	58	Ø8,5x12	X104 B
104 C	150,5	93	140	16	66	37	62	Ø10,5x15	X104 C

110

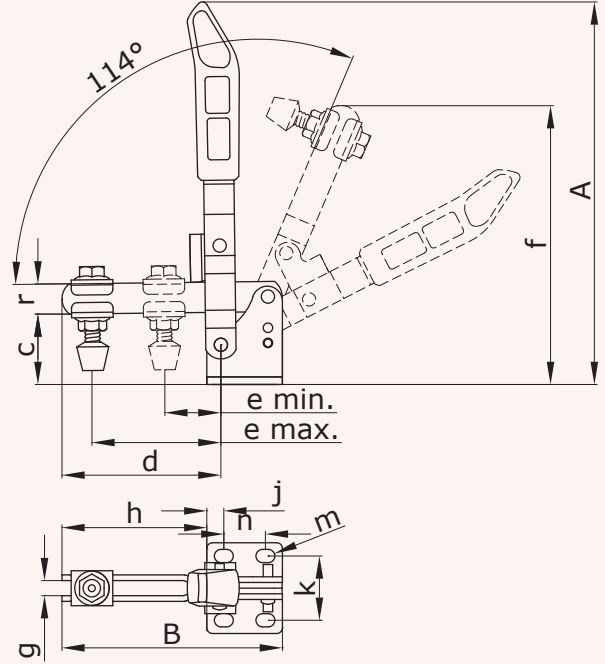

CODE NO	A	B		Gr	Pressure force between e-max. - e-min. (kg)	PASLANMAZ STAINLESS
110 Z	148,5	85	M6x45	180	110 - 220	X110 Z
110 A	202	116,5	M8x60	415	190 - 380	X110 A
110 B	246,5	154	M10x85	900	250 - 500	X110 B
110 C	296	194	M12x95	1590	400 - 800	X110 C

Farklı Sabitleme türleri ile yüzeylere yüksek sıkıştırma kuvveti ileten Dik Pozisyonlu Bağlama Elemanları açık pozisyonda iken 114 derece açılan kol ile geniş hareket olanakları sağlar. Baskı civatası, 2 eksenli hareket imkanı sunarak sabitleme mesafeleri ayarlanabilir.

Vertically Positioned Clamping Components conveying high compression power to the surfaces by means of different fixation types; enables wide movability range with a handle opened for 114 degrees in open position.

Compression bolt, fixation distances can be adjusted by enabling movement in 2 axials.

CODE NO	r	c	d	e max.	e min.	f	g	h	j	k	m	n	PASLANMAZ STAINLESS
110 Z	12	26,5	61,5	50,5	23	119,5	6	56	7	27	Ø6x8,5	15	X110 Z
110 A	16	37	84	68,5	29,5	148	8	76,5	9	34	Ø7x10	22	X110 A
110 B	20	54	112	95	40	170	10	100	13	48	Ø8,5x12,5	28	X110 B
110 C	25	63	145	124	49	244	13	127	18	52	Ø8,5x15,5	31	X110 C

112

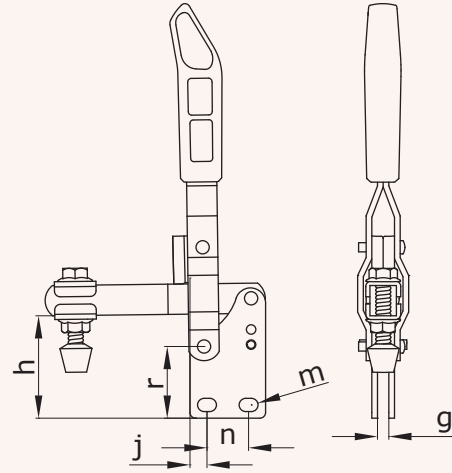

CODE NO	h	r	g	j	m	n	PASLANMAZ STAINLESS
112 Z	39,5	28,5	5	7	Ø6x8,5	15	X 112 Z
112 A	54	38	6	9	Ø7x10	22	X 112 A
112 B	78,5	57	8	13	Ø8,5x12,5	28	X 112 B
112 C	87	67	10	18	Ø8,5x16	31	X 112 C

Dik Bağlama Elemanlarının, farklı ayak yapısına sahip bu modelleriyle çeşitli pozisyonlarda montaj yapılabilir.

By means of these models of Vertical Clamping Components with different foot structure, it is possible for various assembly positions

114

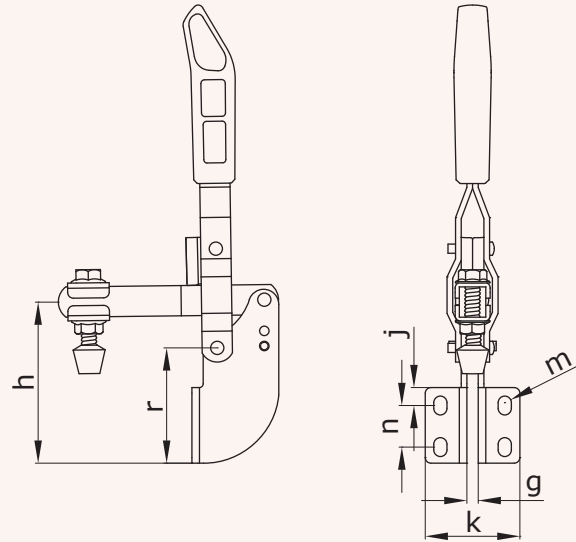

CODE NO	h	r	g	j	m	n	k	PASLANMAZ STAINLESS
114 Z	56,5	45,5	5	7	Ø6x10	17	23,5	X114 Z
114 A	77	61	6	9,5	Ø7x10	22	34	X114 A
114 B	111,5	90	8	13	Ø9x13	28	48	X114 B
114 C	131	110	10	18	Ø8,5x15,5	31	52	X114 C

120

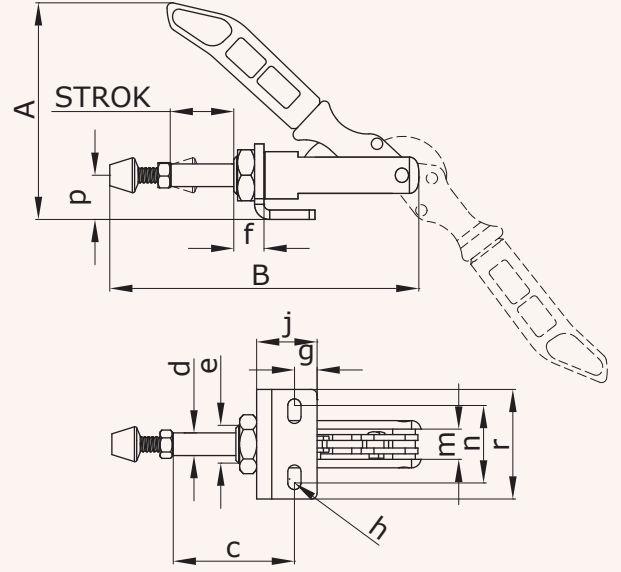

CODE NO	A	B		Gr	Pressure Force (kg)	PASLANMAZ STAINLESS
120 Z	82,5	125	M6x35	265	200	X120 Z
120 A	114,5	164	M8x45	480	280	X120 A
120 B	140,5	190	M10x50	750	450	X120 B

225 derece açılabilen mekanizma kolu sayesinde uzun piston strok boyu ve baskı civatası ayarı ile strok mesafesi ayarlanabilmektedir. Kullanım amaçlarına göre itme ve çekme pozisyonlarında kullanılır.

By means of the mechanism handle which can be opened 225 degrees, the stroke distance can be adjusted with the long piston stroke length and compression bolt adjustment. They are used in pushing and pulling positions depending on the purpose of usage.

CODE NO	c	d	e	f	g	h	j	m	n	r	p	STROK	PASLANMAZ STAINLESS
120 Z	47	Ø10	M16x1,5	11,5	12	Ø6x10,5	25	12	32,5	45	18,5	23,5	X120 Z
120 A	64,5	Ø12	M20x1,5	16	15	Ø7x13	32	16	41	58	23,5	33,5	X120 A
120 B	75	Ø14	M24x1,5	18	15,5	Ø10x17	35	18	48	70	29,5	41,5	X120 B

124 Y

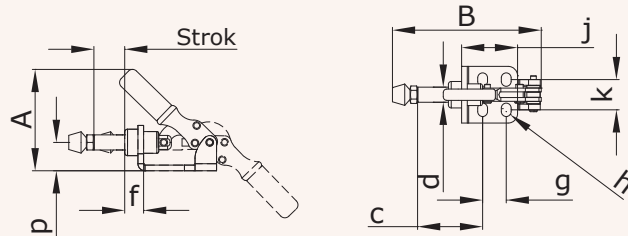

CODE NO	A	B		gr	Pressure Force Between e-max - e-min (kg)
124 Y	49	78,5	M5	91	100

CODE NO	c	d	f	g	h	j	k	p	STROK
124 Y	34,5	8	10	12,5	Ø5,7,5	29,5	16	16	16



122

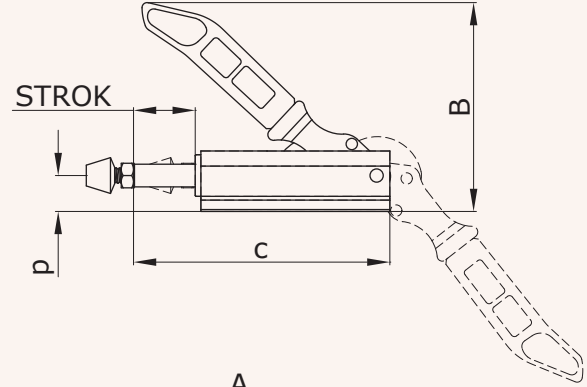
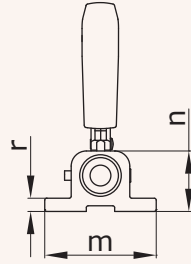
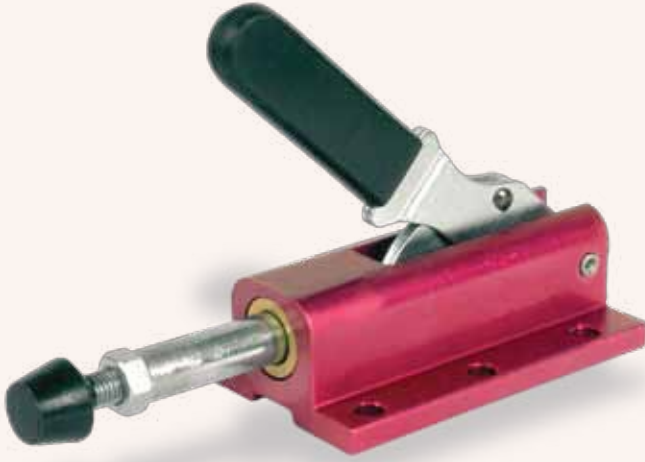

Gövdesi alüminyum malzemeden imal edilmiş olan bu model, hafif olup ağır iş koşullarına elverişlidir.

The body of this model made of aluminum material is light and is convenient for hard working conditions

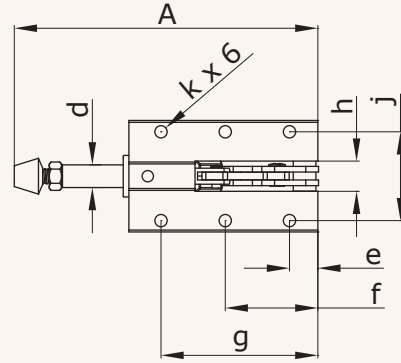

CODE NO	A	B		gr	Pressure Force (kg)
122 A	160,5	110	M8x35	370	350

CODE NO	c	d	e	f	g	h	j	k	m	n	r	p	STROK
122 A	135,5	Ø12	15	49	83	16	47	Ø6,5	59	32	7	19	32.5

140

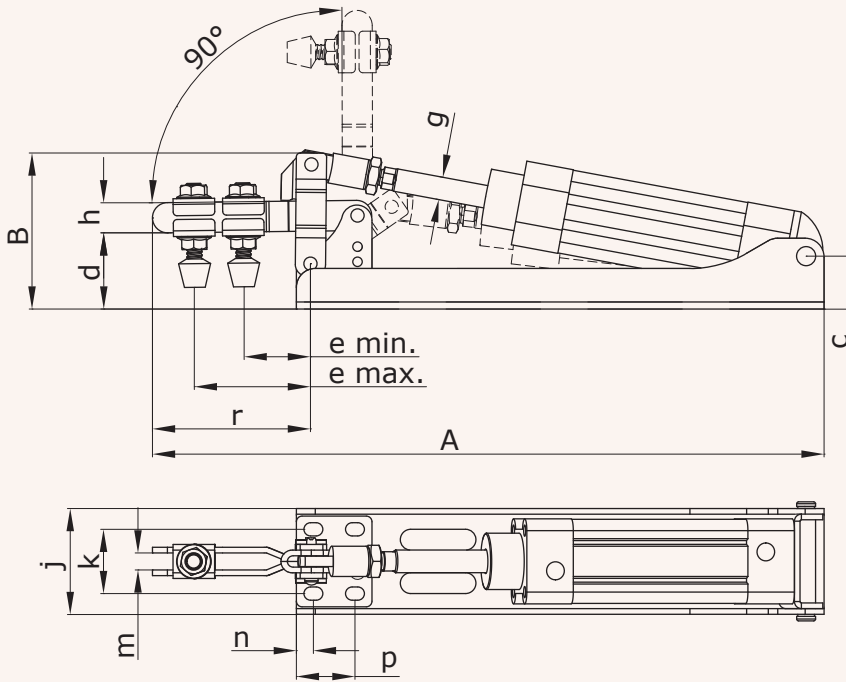
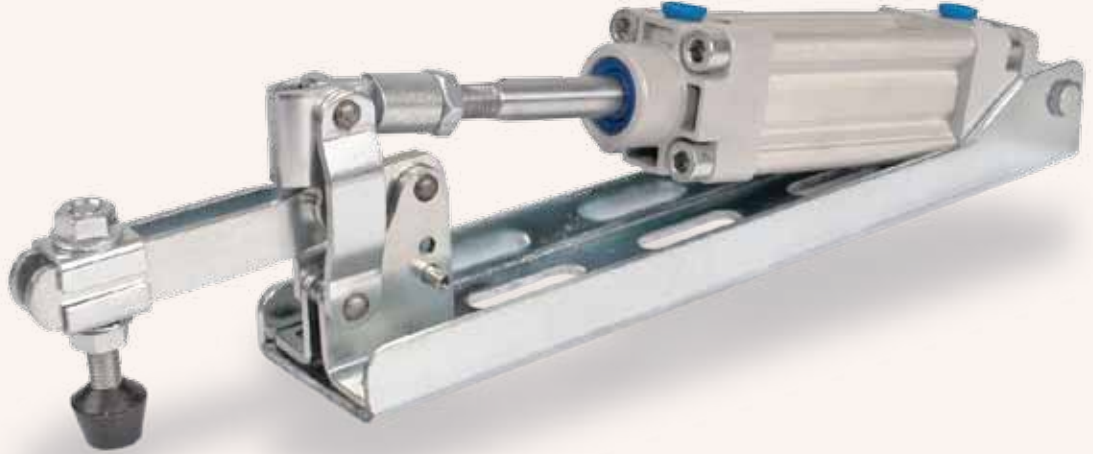

CLAMP Hızlı Bağlama Elemanları'nın, Pnömatik grubu elemanları mekanik sistemlerin gelişmiş versiyonudur. Mekanik sistemlerin sunmuş olduğu pratik çözümlere ek olarak pnömatik sistemler açma kapama işlemini otomatik yapmaktadır. Grup halinde çalıştırılabilir veya kontrol edilebilir imkanı sunar.

The Pneumatic Group Components of CLAMP Fast Clamp Components are the developed version of mechanical systems. In addition to the practical solutions provided by the mechanical systems, the pneumatic systems automatically perform the open-close process. It provides the possibility of group working or checking.

CODE NO	A	B		Gr	Pressure force between e-max. - e-min. (kg)
140 Z	197	61	M6x40	700	150-300
140 A	355.5	82,5	M8x50	1520	200-400
140 B	430	110,5	M10x70	3500	300-500

CODE NO	r	c	d	e max.	e min.	g	h	j	k	m	n	p
140 Z	61	24,5	29,5	50,5	23	Ø10	12	52	27	6	7	22
140 A	83,5	28	40	64,5	34	Ø12	16	56	34	9	9	31
140 B	112	39	56	95	38,5	Ø16	20	78	48	10	13	41

## 142

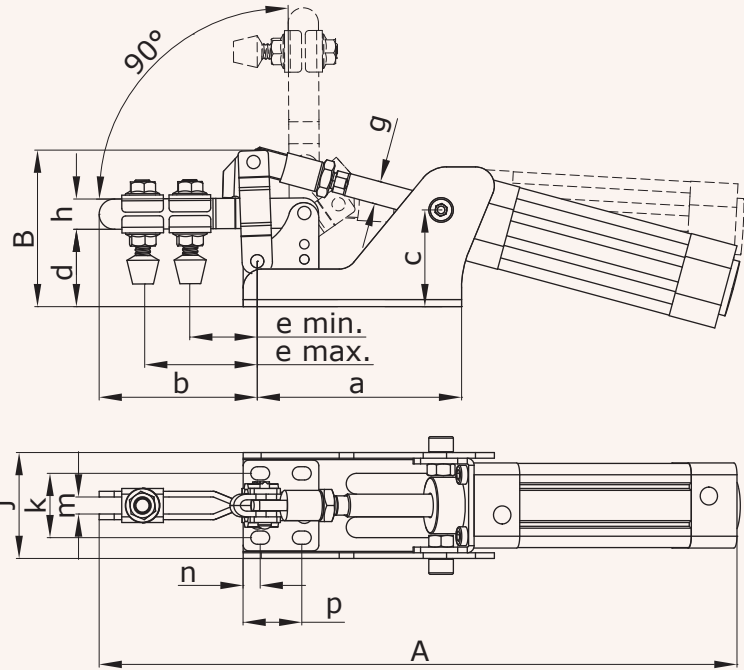
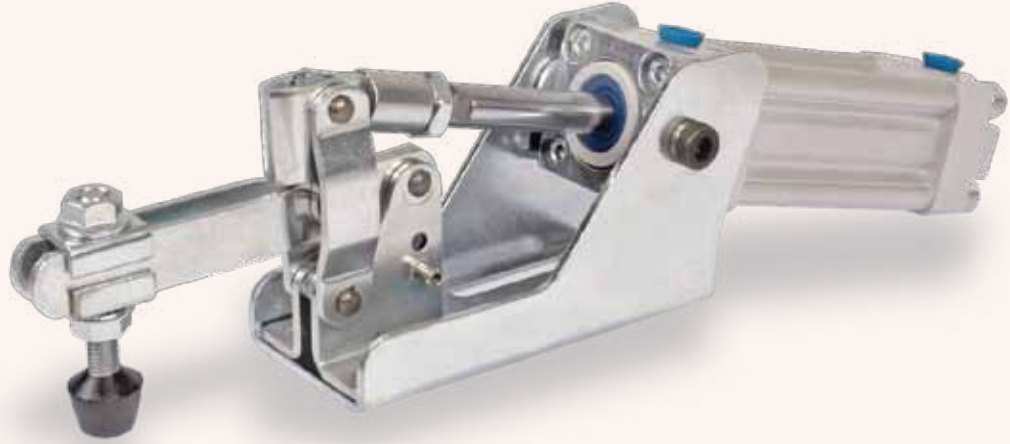

Yeni 142 Serisi CLAMP Hızlı Bağlama Elemanları, kısa ayak yapısıyla uygulama bölgelerine uyum sağlamaktadır.

The new 142 serial adopts to the application areas with its short foot structure.

CODE NO	A	B		Gr	Pressure force between e-max. - e-min. (kg)
142 Z	182	61	M6x40	635	150-300
142 A	339	82,5	M8x50	1450	200-400
142 B	409	110,5	M10x70	1980	300-500

CODE NO	a	b	c	d	e max.	e min.	g	h	j	k	m	n	p
142 Z	56,5	61	39,5	30	50,5	23	Ø10	12	52	27	6	7	22
142 A	108	84	51	40,5	64,5	34	Ø12	16	56	34	9	9	31
142 B	128	112	74	56	95	38,5	Ø16	20	78	48	10	13	41

150

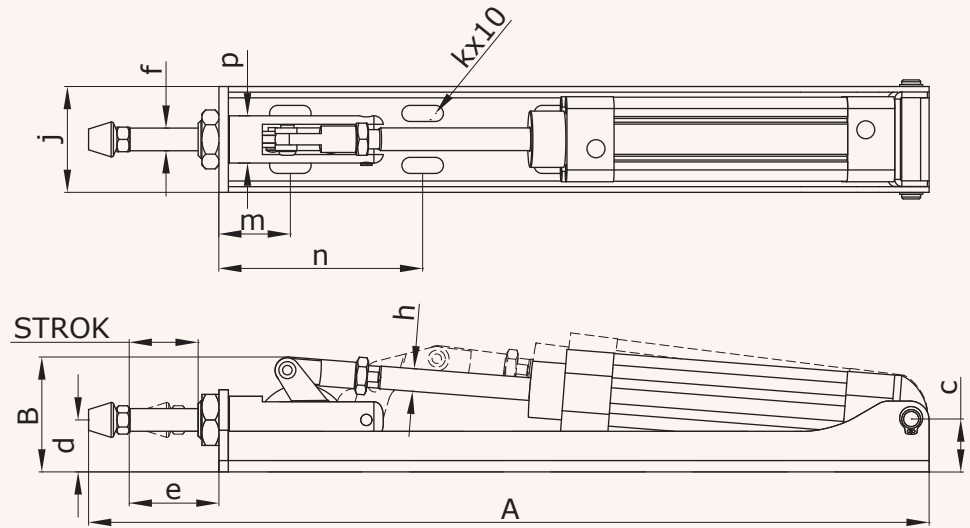
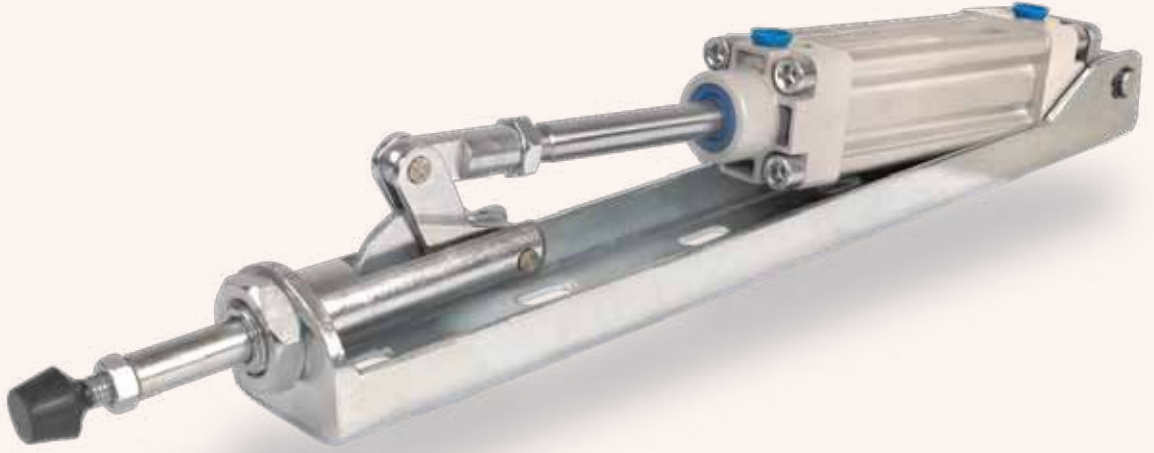

CODE NO	A	B		gr	Pressure Force (kg)
150 Z	254	46	M6x30	1550	300
150 A	444,5	60,5	M8x35	1900	400
150 B	542	77,5	M10x65	2800	600

Pnömatik grubunun itme-çekme pozisyonlu modelidir.

This is the model of the pneumatic group with pushing - pulling positioned.

CODE NO	e	c	d	f	h	j	k	m	n	p	STROK
150 Z	34	24,5	21	Ø10	Ø10	52	Ø7x20	23	73	Ø20	17
150 A	47,5	28	27,5	Ø12	Ø12	56	Ø8,5x22	38	108	Ø25	29
150 B	54,5	32,5	33,5	Ø14	Ø16	66	Ø13x33	51	126	Ø30	31

200

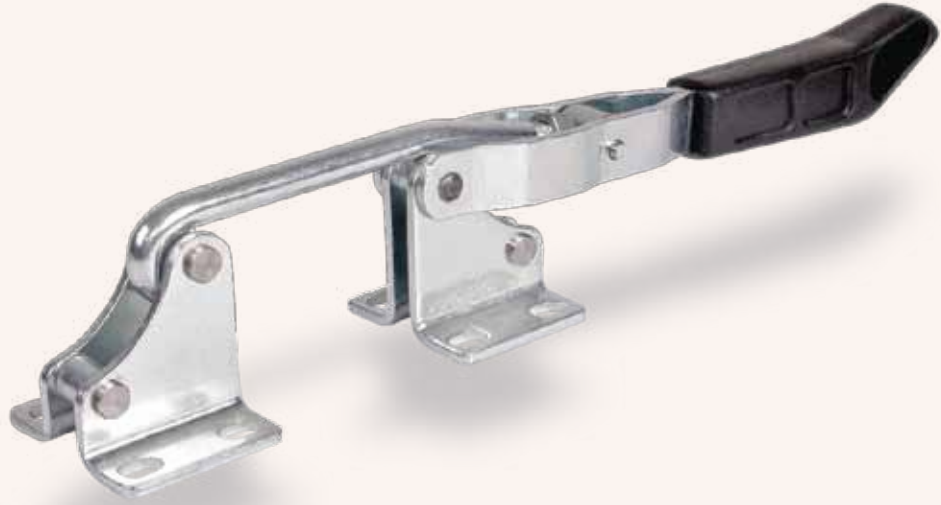

**CLAMP** Kancalı Hızlı Bağlama Elemanları tutma-çekme, yaklaştırma-sabitleme, kapak kilitleme vb. işlemlerde hızlı ve pratik çözümler sunar. Yüksek çekme kuvveti kolay kontrol edebilme ve bağlanabilme en belirgin özellikleri arasındadır.

**CLAMP** Hooked Clamping Components give fast and practical solutions for operations such as holding, pulling, approximation- fixing, locking covers etc. High pulling power, easily controlling and clamping properties are the most significant features.

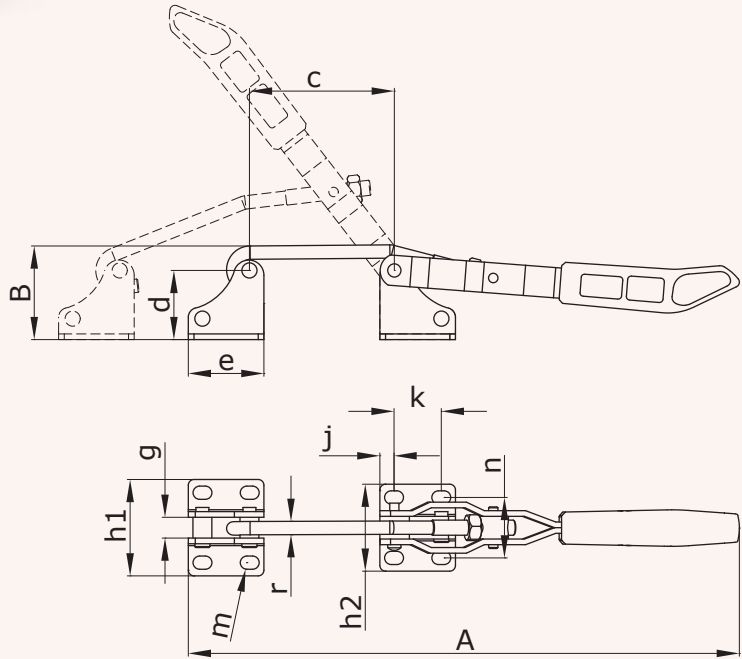

CODE NO	A	B	Gr	Pulling Power (kg)	PASLANMAZ STAINLESS
200 Z	217,5	34	200	150	X200 Z
200 A	291,5	49,5	350	200	X200 A
200 B	344	60,5	650	300	X200 B

CODE NO	c	d	e	g	h1	h2	j	k	m	n	p	r	s	PASLANMAZ STAINLESS
200 Z	56,5	25	31	8	45	42	8,5	14,5	Ø6,5x9	26	50	Q5	90	X200 Z
200 A	76,5	36,5	40	11	51	46	7,5	25	Ø7x10	32	65	Q7	116	X200 A
200 B	85,5	45,5	54	12	70	66	13	28	Ø10x13	47,5	78	Q9	140	X200 B

# TREX<sup>serial</sup>



Kolay kavrama imkânı sunan, el boğumuna göre tasarlanmış dizaynı ve öne doğru verilmiş açısı ile sağladığı rahat hareket alanı el bileğinin yorulmasını azaltan, -40 / + 120 dereceye dayanıklı özel alaşımlı kompozit sap, siyah rengin metal ile olan uyumunu da ispatlamaktadır.

Special alloy composite easily grasped handel angled frontward thus reducing the fatigue of wrist with its design according to hand's node resistant to -40/+120 degrees also proves the compatibility of black with metallic colours.

Mukavemet dayanımı yüksek çelikten imal edilmiş, kavisli dizaynı, paslanmaz perçinleri ile güçlendirilmiş montajı sayesinde kuvvetli bir o kadar zarif görüntüsüyle Clamp'in ana gövdesini teşkil etmektedir.

It constitutes the main body of Clamp with is strong and also smart image thanks to the reinforced installation with rust-free rivets, arched design and high endurable steel.

Özel Kilit Mekanizmasıyla darbe, titreşim, çarpma vb. gibi istem dışı oluşabilecek etkenlere karşı Clamp' in açılması engellenir. Kilidin açılması tamamen kullanıcının elle müdahalesi ile gerçekleşir. Çeşitli iş konuları düşünülerek tasarlanmış ergonomik aksesuarımız; gerek kullanıcının isteğine ve gerekse konumlandırıldığı yere uyum sağlayabilmesi açısından Clamp' in sağ ve sol taraflarında kullanılabilme özelliğine sahiptir. Estetik görüntüsü ile ürünle bütünlük sağlayan mekanizma, kullanım kolaylığı, sağlamlığı ve görüntüsü ile fark yaratmaktadır.

With its Special kit, The Clamp's opening is blocked against unwilled factors such as impact,vibration and strikes. Unlocking is carried out only by means of the complete intervention of users with hands. This ergonomic property prepared by considering several work areas has the feature of being able to be used either in the left or right parts of the clamp in terms of both suiting to the location and the will of users. The mechanism providing unity with the product with its aesthetic image makes difference with easiness, durability and image.

Clamp kapandıktan sonra yanal hareketleri karşılayan mekanizma yatağı.

The mechanism kit fulfilling lateral movemant when the clamp is closed

-40 / +120 dereceye dayanıklı, yağa karşı mukavemetli baskı civatası.



Pressure boldresisting to oil and endurable to -40/+120 degrees

Ana gövdeye paslanmaz perçinlerle monte edilmiş ayaklar, kullanım alanlarına göre yatay, dik ve yan olmak üzere üç farklı çeşitte kullanılabilirler

The legs installed to the main board with rust-free rivets can be used vertically horizontally and level in three different ways.

# YA 10



CODE NO	A	B		Gr	Pressure force between e-max. - e-min. (kg)	PASLANMAZ STAINLESS	
YA 1010	163	43,5	M6x45	180	110 - 220	YA 1010 X	-
YA 1020	229	60,5	M8x60	390	190 - 380	YA 1020 X	1000 A
YA 1030	282,5	75	M8x82	840	250 - 500	YA 1030 X	1000 B
YA 1040	328,5	93	M10x95	1410	400 - 800	YA 1040 X	1000 C

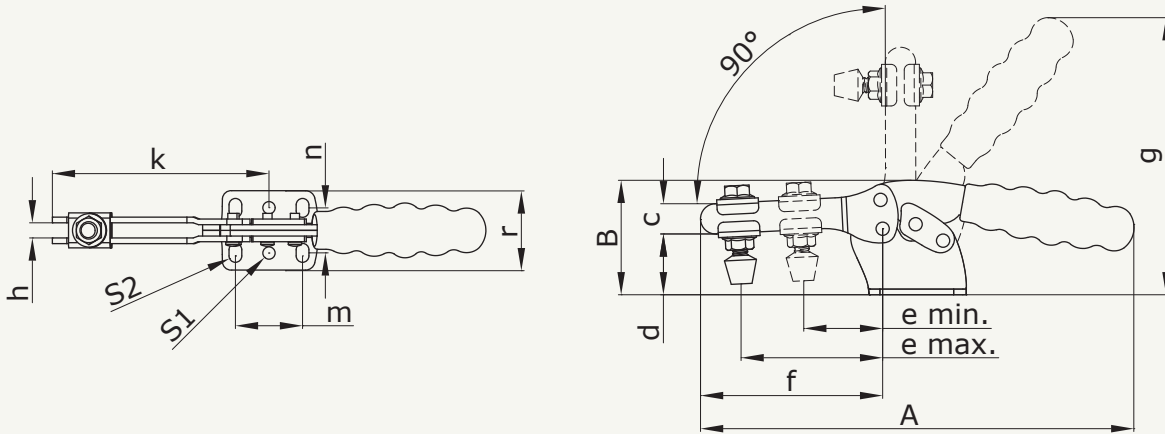

CODE NO	c	d	f	e max.	e min.	g	h	k	m	S1	S2	n	r
YA1010	14	21,5	66,5	53	20	105,5	6	-	23,5	-	Q5,5x10	22	38
YA1020	16	32	96,5	76	37,5	144,5	8	114,5	35,5	Q6,5	Q6,5x10	24	42
YA1030	20	38	125	107	45	171,5	10	146,5	42	Q8,5	Q9x12	36	60
YA1040	24	45	150	130	55	205,5	12	176,5	50	Q10,5	Q11x15,5	37,5	62



## YA 12

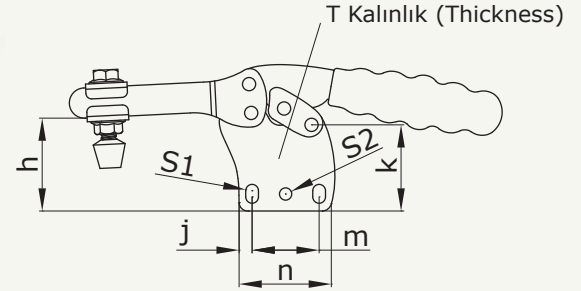

CODE NO	h	k	m	n	j	S1	S2	T	PASLANMAZ STAINLESS	
YA1210	37,5	37	23,5	36	6	Ø5,5x10	-	5	YA1210 X	-
YA1220	49	45,5	35,5	49	7	Ø6,5x10	Ø6,5	6	YA1220 X	1000 A
YA1230	63	57	42	60	10	Ø9x12	Ø8,5	8	YA1230 X	1000 B
YA1240	69,5	67	50	74	13	Ø11x15,5	Ø10,5	10	YA1240 X	1000 C

Yeni Clamp Trex Yatay Hız Bağlama Elemanlarının çeşitli yapıdaki ayakları uygulamada alternatifler üretmektedir.

The various structure feet of new Clamp Trex horizontal fast clamping componets components create alternatives in application.

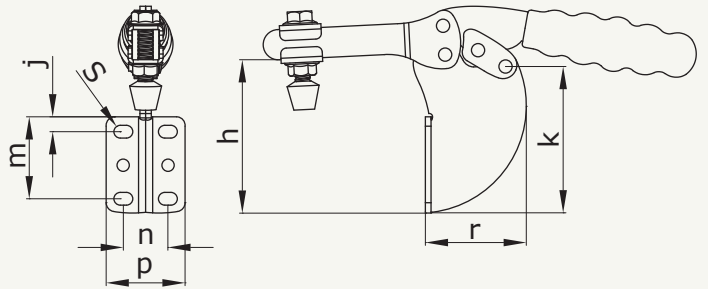

## YA 14

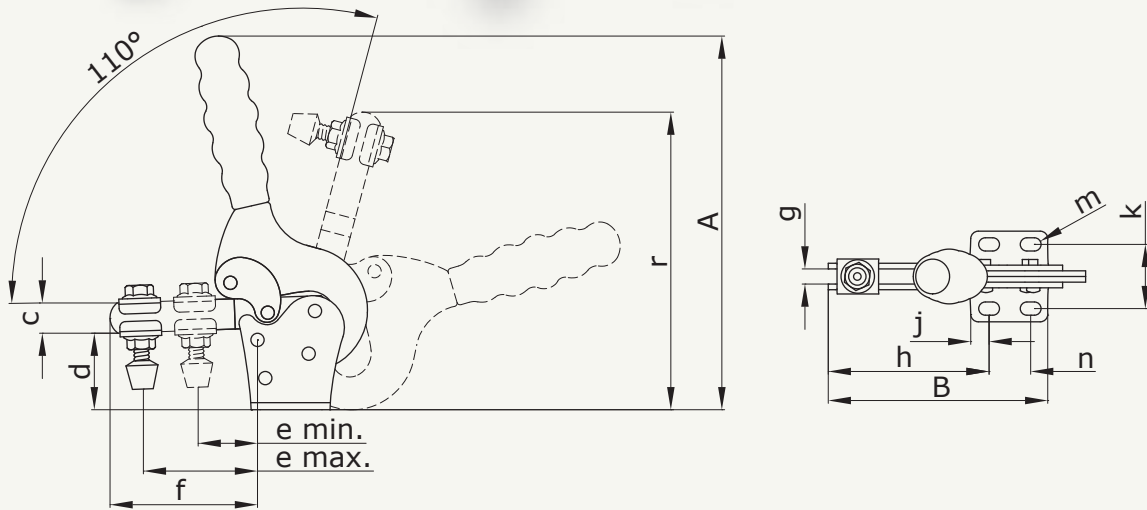

CODE NO	h	r	k	j	m	n	p	S	PASLANMAZ STAINLESS	
YA1410	58	39,5	57,5	6	30	22	38	Ø5,5x10	YA1410 X	-
YA1420	81	53,5	77,5	8	43,5	24	42	Ø6,5x10	YA1420 X	1000 A
YA1430	99,5	71	93,5	10,5	52,5	36	60	Ø9x12	YA1430 X	1000 B
YA1440	119	85,5	116,5	14	64	38	62	Ø11x15,5	YA1440 X	1000 C

# DK 20



CODE NO	A	B		Gr	Pressure force between e-max. - e-min. (kg)	PASLANMAZ STAINLESS	
DK 2000	70	47	M4x30	59	25-40	DK 2000 X	-
DK 2010	146,5	87	M6x45	235	110 - 220	DK 2010 X	-
DK 2020	198	116	M8x60	410	190 - 380	DK 2020 X	1000 A
DK 2030	237	151	M10x85	900	250 - 500	DK 2030 X	1000 B
DK 2040	284,5	186	M12x95	1595	400 - 800	DK 2040 X	1000 C

CODE NO	c	d	f	e max.	e min.	h	g	k	m	n	j	r
DK 2000	6	16,5	32	26	11	35	4	16,5	Ø4x5,5	8	4,5	64
DK 2010	12	29,5	58,5	48	24	64,5	6	27	Ø5,5x8	15	8	118,5
DK 2020	16	40,5	78	62,5	33	85	8	34	Ø7x11	22	10	157,5
DK 2030	20	50,5	101,5	84	41	110,5	10	48	Ø8,5x12	28	12,5	206
DK 2040	25	68	125	103,5	50	137,5	13	52	Ø11x14	31	17	247

## DK 22

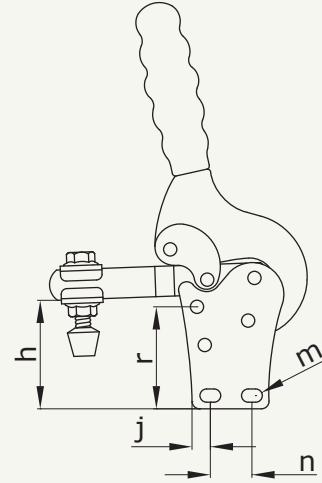

CODE NO	h	r	j	m	n	PASLANMAZ STAINLESS	
DK 2200	23,5	21,7	4,5	Ø4x5,5	8	DK 2200 X	-
DK 2210	43	40,5	8	Ø5,5x8	15	DK 2210 X	-
DK 2220	57,5	54	10	Ø7x11	22	DK 2220 X	1000 A
DK 2230	75,5	70	12,5	Ø8,5x12	28	DK 2230 X	1000 B
DK 2240	92	86,5	17	Ø11x14	31	DK 2240 X	1000 C

Yeni Clamp Trex Dik Hız Bağlama Elemanlarının çeşitli pozisyonadaki ayak yapıları montaj bölgelerine uyum sağlamaktadır.

The feet of New Clamp Trex Vertical Fast Clamp Components in different positions are in compliance with assembly areas.

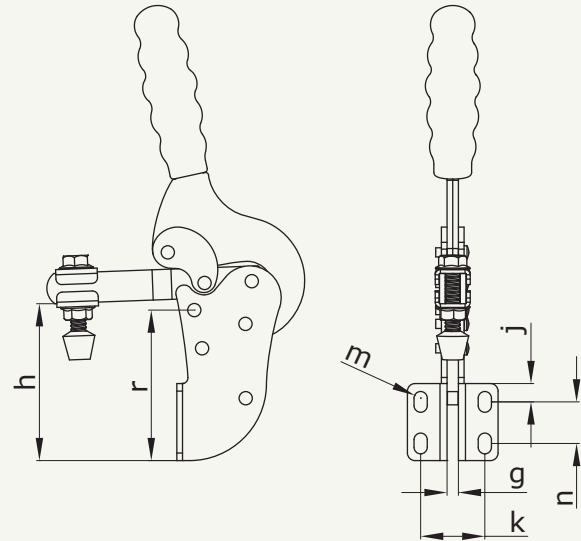

## DK 24

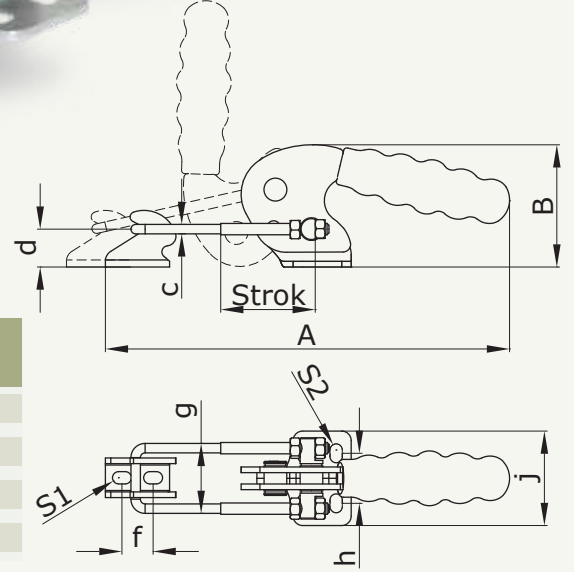

CODE NO	h	r	j	m	n	g	k	PASLANMAZ STAINLESS	
DK 2400	34	32	4,5	Ø4x5,5	8	4	18	DK 2400 X	-
DK 2410	62,5	59,5	7	Ø5,5x8	15	5	27	DK 2410 X	-
DK 2420	83	79,5	9,5	Ø7x11	22	6	34	DK 2420 X	1000 A
DK 2430	109	103,5	11	Ø8,5x12	28	7,5	47,5	DK 2430 X	1000 B
DK 2440	133,5	127,5	17	Ø11x14	31	10	52	DK 2440 X	1000 C

## KA 50



CODE NO	A	B		Gr	Pulling Power (kg)	PASLANMAZ STAINLESS	
KA 5010	171,5	49	M6	225	110	KA 5010 X	-
KA 5020	222	64,5	M6	385	200	KA 5020 X	1000 A
KA 5030	278,5	83,5	M8	835	360	KA 5030 X	1000 B
KA 5040	324,5	93,5	M10	1375	500	KA 5040 X	1000 C

CODE NO	c	d	STROK	g	f	h	j	S1	S2
KA 5010	Ø6	15	55	37	14,5	23	42	Ø5,5x8,5	Ø6x9
KA 5020	Ø6	20	58	37	16,5	26,5	50	Ø6,5x10	Ø6,5x10
KA 5030	Ø8	28	60,5	51	21,5	31,5	60	Ø8,5x13	Ø8,5x13
KA 5040	Ø10	30	90	57	28	43,5	76	Ø10,5x16	Ø10,5x20,5

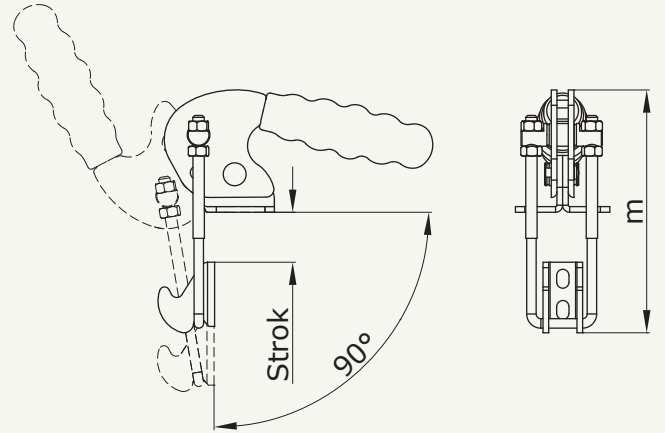

CODE NO	STROK	m
KA 5010	21	100,5
KA 5020	27	129
KA 5030	29	161
KA 5040	50	200

Trex KA 50 serisinin çoklu bölgelerine uyumluluğu sağlayan değişken yapısı sayesinde kanca kısmı yatay veya dikey pozisyonlarda kullanılabilir.

By means of the changing structure of Trex KA 50 series which enables harmony in its assembly regions by presenting multiple alternatives, the hook part can be used in horizontal or vertical positions.

## KA 70

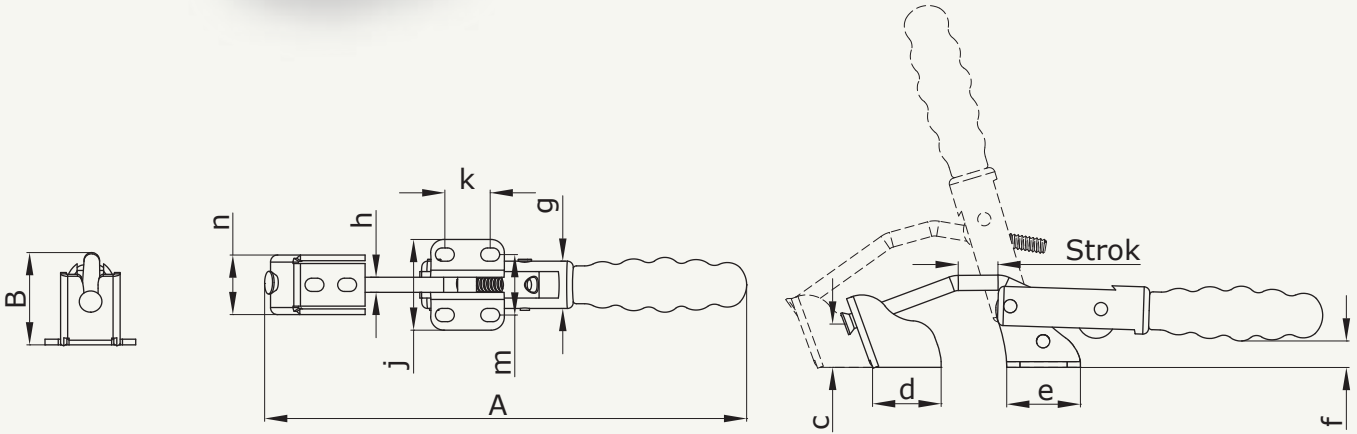

Yeni Clamp Trex serisinin en özel modellerinden **KA 70** serisi kancalı bağlama elemanı yüksek çekme ve sabitleme kuvveti sayesinde uygulama bölgesinde kolaylık sağlar.

The hooked clamp component of the new Clamo Trex series **KA 70** series among the most special models enables facility in the application area by means of high pulling and fixing power.

CODE NO	A	B	M	Gr	Pushing - Pulling Power (kg)	PASLANMAZ STAINLESS
KA 7010	174,5	34,5	M6	250	100	KA 7010 X
KA 7020	255	49	M8	400	150	KA 7020 X
KA 7030	317,5	63	M10	600	250	KA 7030 X

CODE NO	c	d	e	f	g	j	k	m	n	h	STROK
KA 7010	19	25,5	30,5	10	20	35	20	24	22	Ø5	14,5
KA 7020	23,5	36	39	14	25	48	24	32	31,5	Ø8	21
KA 7030	38	47	50,5	15	32,5	62,5	31	41,5	41	Ø10,5	27,5

## KA 90

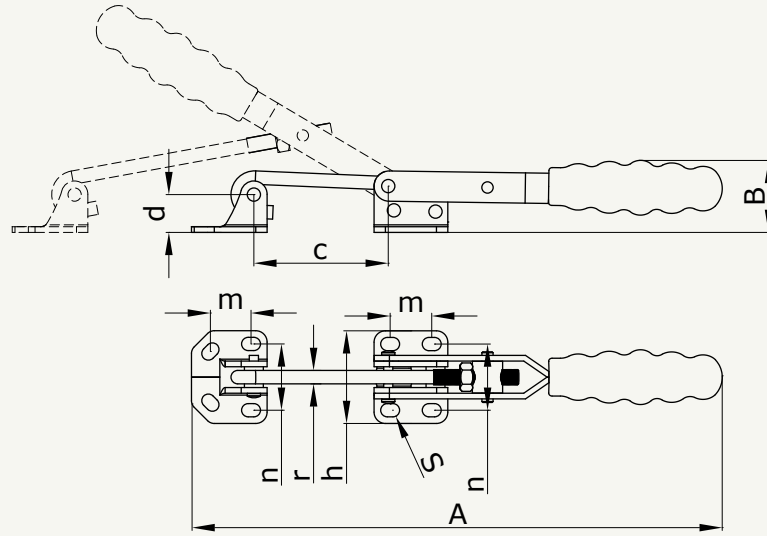

CODE NO	A	B	Gr	Pulling Power (kg)	c	d	m	n	r	h	S
KA 9010	198	26	293	150	48	14	15	25	M6	35,5	Ø6x7
KA 9020	281	38	391	200	71	20	22	35	M8	49	Ø7x10
KA 9030	345	50	510	300	89	26	29	46	M10	64	Ø9x13

## PB 90

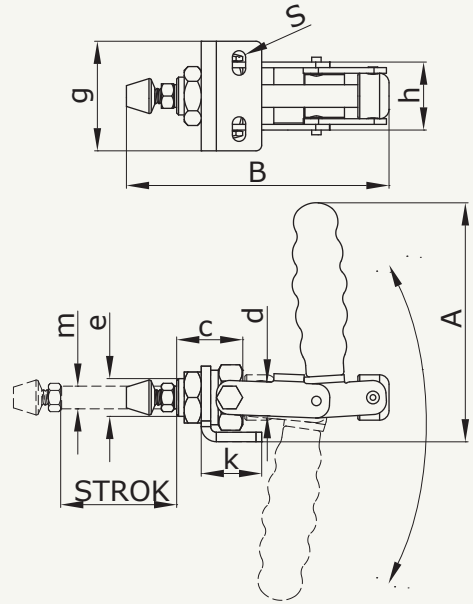

CODE NO	A	B		Gr	Pushing - Pulling Power (kg)	PASLANMAZ STAINLESS
PB 9000	63	71.5	M5	90	80	PB 9000 X
PB 9010	92	94	M6	230	100	PB 9010 X
PB 9020	126.5	139	M8	565	250	PB 9020 X
PB 9030	149	171	M10	1490	400	PB 9030 X

Yeni Clamp Trex serisinin, yüksek stroklu işlerde kullanıma elverişli modeli **PB 90** serisi uygulama bölgelerinde itme veya çekme proseslerini yerine getirir.

**PB 90** series of the new Clamp Trex series which is suitable for usage in high stroke works, performs pushing or pulling processed in application areas.

CODE NO	e	c	d	k	g	h	m	s	STROK
PB 9000	M12x1	17.5	9	20	31	18	Ø7	Ø5x8	30
PB 9010	M16x1,5	24	12	25	45	24	Ø10	Ø6x10.5	43.5
PB 9020	M20x1,5	35	18	32	58	36	Ø12	Ø7x13	62.5
PB 9030	M24x1,5	47	22	35	70	46	Ø16	Ø10x17	74

# PN 70

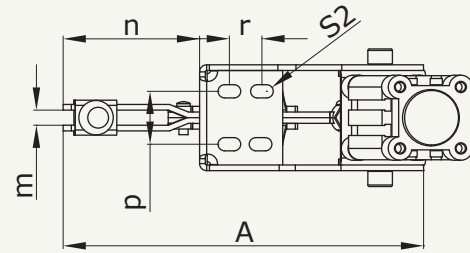
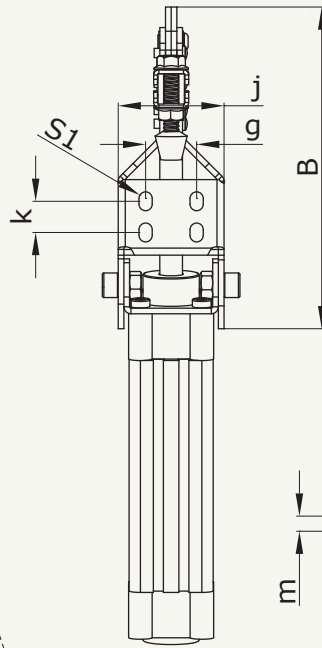
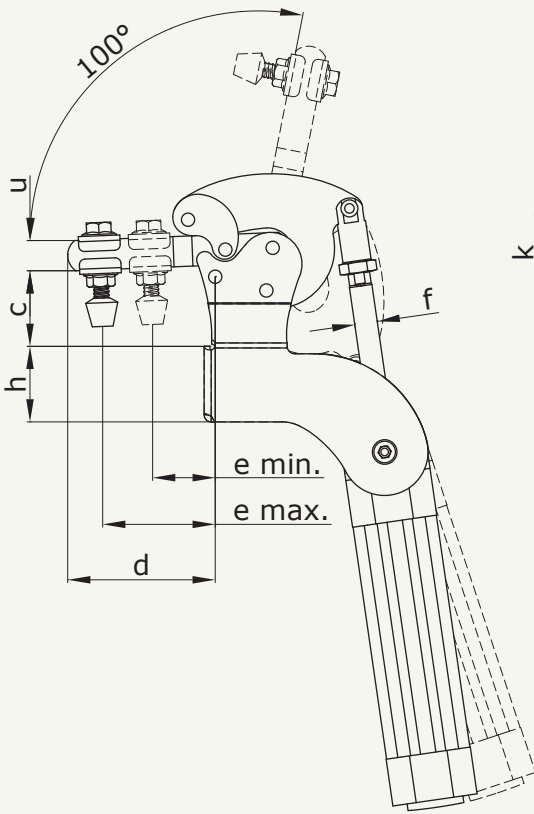

CODE NO	A	B		Gr	Pressure force between emax-emin (kg)
PN 7020	193	170	M8x60	1500	200 - 400

CODE NO	u	c	e max.	e min.	d	h	S1	S2	f
PN 7020	16	39	63	33	78	38	Ø7x10	Ø7x12	Ø12

CODE NO	k	j	g	r	p	n	m
PN 7020	16,5	56	27	17	28	72	8

Yeni Clamp Trex serisinin fonksiyonel pnömatik modeli **PN 70** serisi, dar alanlara uygun fiziği ve tek parça ayak yapısıyla proseslere pratiklik kazandırmaktadır.

The New functional pneumatic model of Clamp Trex series **PN 70** series provides practice to the processes together with its physics appropriate for the narrow places and single form foot structure.



500

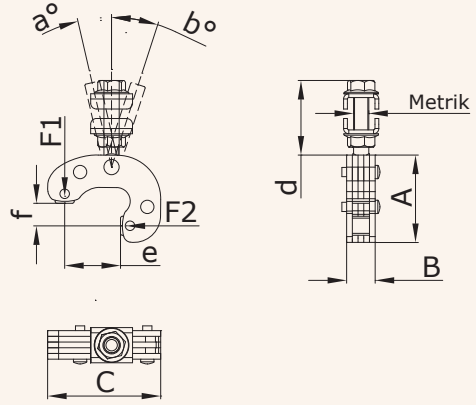

İki taraflı sıkma ve sabitleme gereksinimlerinde tek bir CLAMP Hızlı Bağlama Elemanına ilave edilecek İki Yönlü Sıkma Aksesuarı zamandan ve paradan tasarruf etmenizi sağlar. CLAMP hızlı bağlama ekipmanlarının Klasik Seri ve Trex Serilerinin istediğiniz ürününde bu aksesuar kullanılabilir.

CODE NO	A	B	C	Metrik	Gr	a°	b°	d	e	f	F1 Kg	F2 Kg
500 Z	32	12.5	42	M6	150	11	16	28	21	8	200	200
500 A	46	15	59,5	M8	215	13	18	40	29	12	350	350
500 B	59	20	77	M10	280	13	18	52	38	15	450	450
500 C	73	25	95	M12	345	15	20	65	47.5	18.5	700	700

A two-way clasp accessory which will be added to CLAMP Quick Fastener will save you from time and expense in cases where two-way clamping and fixation needed. You can use this accessory in Classic and Trex series of CLAMP Quick Fasteners.

### İki Yönlü Baskı

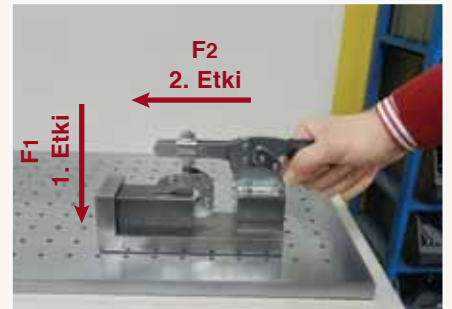

### CLAMP'ın Her Modeline Uygun

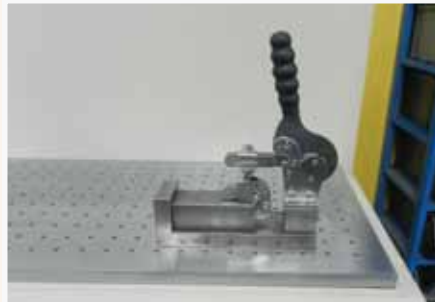

### Kolay Parça Alımı



**Baskı Civatası 1 Pressure Bolt 1**

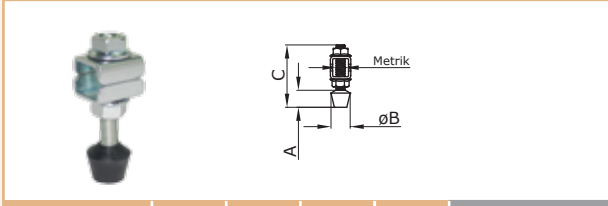

CODE NO	A	B	C	M	PASLANMAZ STAINLESS
400 A	15	20	60	8	X 400 A
400 Z	13	15	45	6	X 400 Z
400 B	20	23	85	10	X 400 B
400 C	22	25	95	12	X 400 C

**Baskı Civatası 2 Pressure Bolt 2**

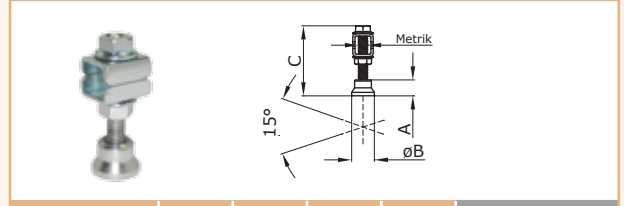

CODE NO	A	B	C	M	PASLANMAZ STAINLESS
300 A	15	20	60	8	X 300 A
300 Z	13	15	45	6	X 300 Z
300 B	20	23	85	10	X 300 B
300 C	22	25	95	12	X 300 C

**Baskı Civatası 3 Pressure Bolt 3**

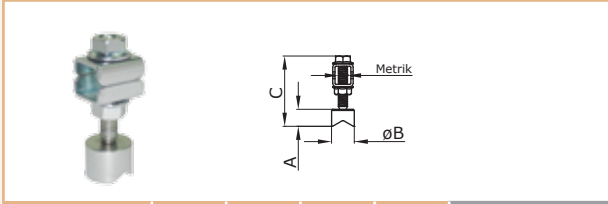

CODE NO	A	B	C	M	PASLANMAZ STAINLESS
350 A	15	20	60	8	X 350 A
350 Z	13	15	45	6	X 350 Z
350 B	20	23	85	10	X 350 B
350 C	22	25	95	12	X 350 C

**Kilit Mekanizması Locking Mechanism**



CODE NO	A	B	Metrik	PASLANMAZ STAINLESS
1000 A	23,5	16	M8x1	X 1000 A
1000 B	30,5	21	M10x1	X 1000 B
1000 C	38,5	26	M12x1	X 1000 C

**Çift Baskı Grubu Double Pressure Group**

CODE NO	A	B	C	PASLANMAZ STAINLESS
700 A	100	65	16	X 700 A
701 A	120	85	16	X 701 A
702 A	140	105	16	X 702 A
703 Z	80	55	12	X 703 Z
704 Z	95	70	12	X 704 Z
705 Z	110	85	12	X 705 Z
706 B	100	65	20	X 706 B
707 B	150	110	20	X 707 B
708 B	180	130	20	X 708 B
709 C	150	100	25	X 709 C
710 C	180	120	25	X 710 C
711 C	220	160	25	X 711 C

**Klasik Seri Plastik Sap Classic Series Plastic Handle**

CODE NO	A	B
550 Z	20	55
550 A	28	94
550 B	35	115
550 C	42	128

**Trex Serisi Plastik Sap Trex Series Plastic Handle**

CODE NO	A	B
800 Z	23,5	65
800 A	29	91
800 B	36	102
800 C	41	112

KA 50 Kanca KA 50 Hook

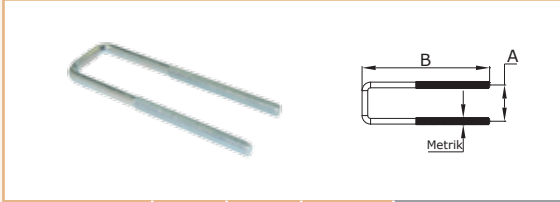

CODE NO	A	B	C	PASLANMAZ STAINLESS
900 Z	32	95	6	X 900 Z
900 A	32	115	6	X 900 A
900 B	44	144	8	X 900 B
900 C	48	190	10	X 900 C

KA 70 Kanca KA 70 Hook

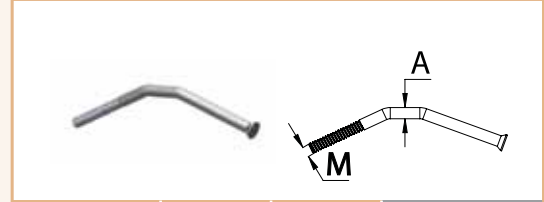

CODE NO	A	M	PASLANMAZ STAINLESS
850 Z	6	M6	X 850 Z
850 A	8	M8	X 850 A
850 B	10	M10	X 850 B

KA 90 Kanca KA 90 Hook

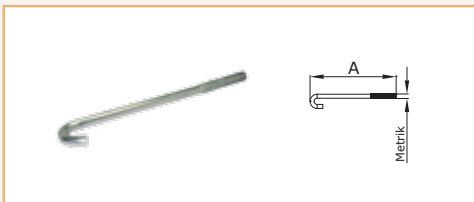

CODE NO	A	B	PASLANMAZ STAINLESS
625 Z	106	6	X 625 Z
625 A	152	8	X 625 A
625 B	198	10	X 625 B

200 Kanca 200 Hook

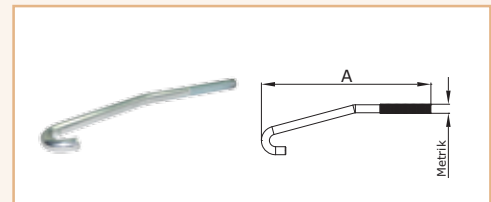

CODE NO	A	Metrik	PASLANMAZ STAINLESS
600 Z	107	6	X 600 Z
600 A	150	8	X 600 A
600 B	184	10	X 600 B

200 Kanca Karşılığı 200 Parts For The Hook

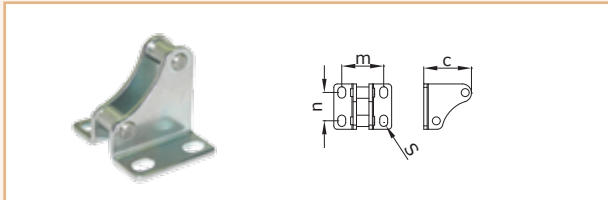

CODE NO	m	n	c	s	PASLANMAZ STAINLESS
650 Z	29	14,5	31	Ø6,5x9	X 650 Z
650 A	37	25	42	Ø7x10	X 650 A
650 B	51,5	28	54	Ø10x13	X 650 B

KA 90 Kanca Karşılığı KA 90 Parts For The Hook

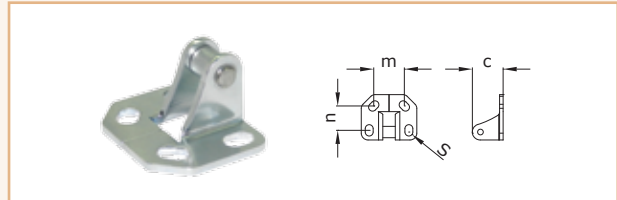

CODE NO	m	n	c	s	PASLANMAZ STAINLESS
750 Z	17	15	19	Ø5x7	X 750 Z
750 A	27	22	27	Ø7x10	X 750 A
750 B	35	28	35	Ø9x13	X 750 B

KA 50 Kanca Karşılığı KA 50 Parts For The Hook

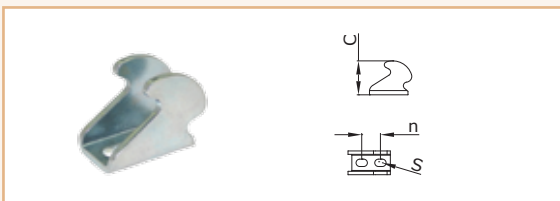

CODE NO	n	c	S	PASLANMAZ STAINLESS
950 Z	14,5	25	Ø6x8	X 950 Z
950 A	16,5	30	Ø7x10	X 950 A
950 B	21,5	41	Ø8,5x13	X 950 B
950 C	28	46	Ø10,5x16	X 950 C

Clamp Mekanik ve Pnömatik sistemlerin tamamlayıcı aksesuarları ve yedek parça çeşitleriyle kullanıcılarına kolaylık sağlar. Kullanıcıdan gelebilecek taleplere göre yedek parça temini veya yeni tasarım çeşitleri yapılabilmektedir.

Clamp enables facility for their users with complementary accessories and spare parts of mechanic and pneumatic systems. Depending on the requests of the user spare part procurement or new design types may be created.





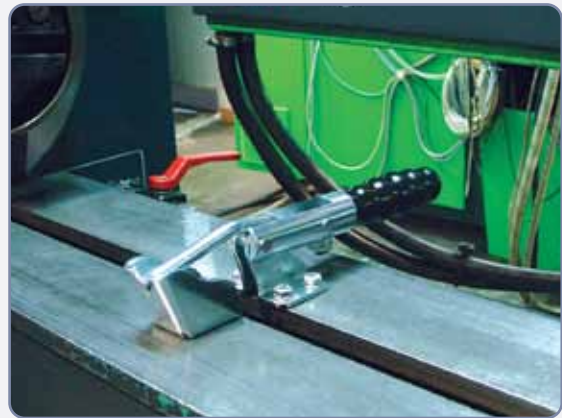

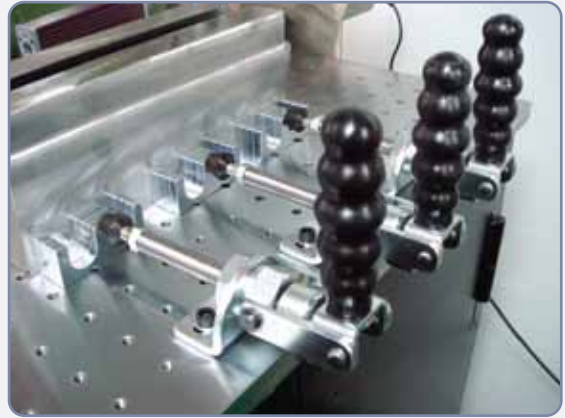



# T R e x s e r i a l

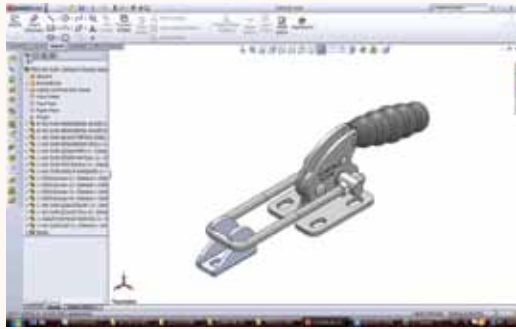

Ürünlerin 3D Formatlarını temin etmek için lütfen bizimle irtibata geçiniz...

3D Formats of products, please contact us in order to ensure ...

clamp@clamp.com.tr



www.toggleclamps.com.tr  
www.clamp.com.tr

**CLAMP METAL SAN. ve TİC. LTD. ŞTİ.**

İKİTELLİ O.S.B. Çevre Sanayi Sitesi 1. Blok No.13 - 15 P.K. 34306  
BAŞAKŞEHİR / İSTANBUL / TURKEY - www.clampmetal.com  
T.: +90 212 671 59 20 - 21 -22 (PBX) - F.: +90 212 671 59 23